



# EZER™ Dengue IgG/IgM/NS1 Combo Rapid Test Device



## INTENDED USE

The Dengue IgG/IgM/NS1 Combo Rapid Test Device is a lateral flow chromatographic immunoassay for the qualitative detection of Dengue IgG, IgM and NS1 in human whole blood, serum or plasma.

# DENGUE



Hangzhou Genesis Biodetection and Biocontrol Co., Ltd.

+86-571 878 18163

[www.genesis-ivd.com](http://www.genesis-ivd.com)

310018

No.139, St.10th (East), Hangzhou Economic & Technological Development Zone.

# PERFORMANCE CHARACTERISTICS

EZER™ Dengue IgG/IgM/NS1 Combo Rapid Test Device	Relative Sensitivity	Relative Specificity
NS1 VS EIA	97.40%	100%
IgG/IgM vs Elisa	97.40%	100%

## PROCEDURE

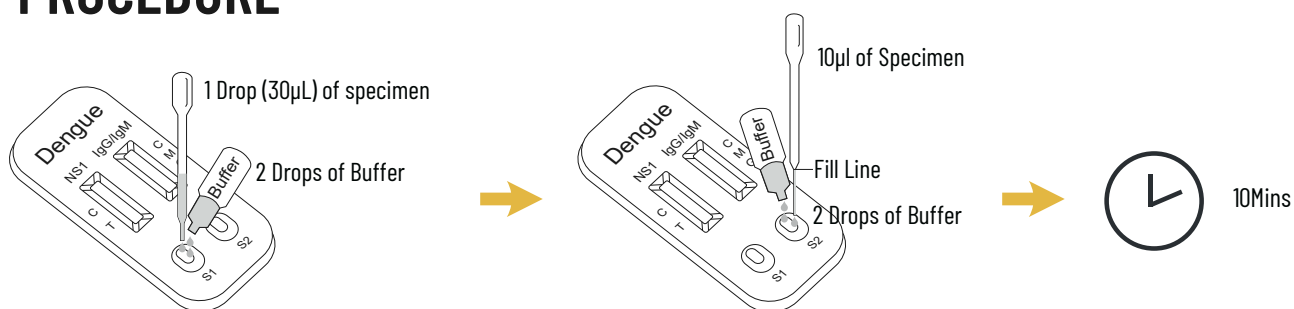

## RESULTS

### Dengue IgG/ IgM Rapid Test

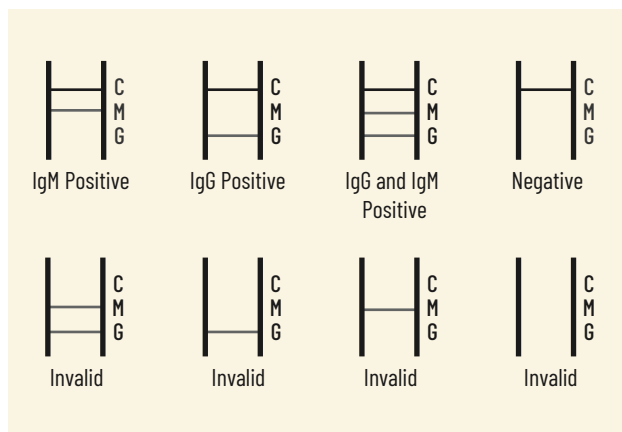

### Dengue NS1 Rapid Test

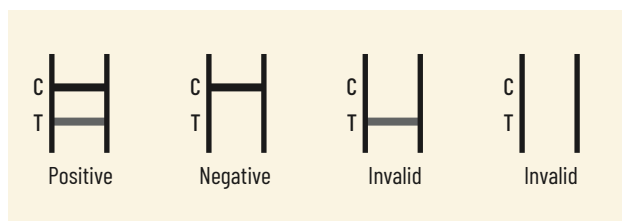

## AVAILABILITY

Product	EZER™ Dengue IgG/IgM/NS1 Combo Rapid Test Device
Cat. No.	P231105
Test Device	20
IgG/IgM Plastic Dropper (10µL)	20
NS1 Plastic Dropper (30µL)	20
Sample Buffer	1
Package Insert	1